

The Circle

Convention Center
Zurich Airport



LOCATION

- Located in the heart of the Circle, the new destination in Zurich, where business meets lifestyle and nature
- Within walking distance from Zurich Airport
- The Circle combines seven modules with Brands & Dialogue, Headquarters & Offices, Hotels & Convention, Dining & Events, Health & Beauty, Art & Culture and Education & Knowledge
- Situated at the most accessible and most well-connected location in Switzerland, directly connected with the city center of Zurich by all means of transportation

THE CIRCLE CONVENTION CENTER

- Over 2,800 sq m of flexible event space
- All event rooms offer an abundance of natural daylight with floor-to-ceiling windows
- The main Convention Hall is the largest space at The Circle Convention Center with 1,292 sq m
- 17 additional meeting rooms ranging from 30 to 290 sq m spread over 3 levels
- Managed and catered by Hyatt Regency Zurich Airport The Circle
- All event rooms are equipped with the latest technologies
- Dedicated in-house audiovisual services
- Complimentary high-speed Wi-Fi connection in all event rooms and public areas
- Virtual studio for digital events

ACCOMMODATION

- The Circle Convention Center is directly connected to Hyatt Regency Zurich Airport The Circle and within walking distance from Hyatt Place Zurich Airport The Circle, both hotels offering a combined capacity of 555 guestrooms

Hyatt Regency Zurich Airport The Circle

- Hyatt Regency Zurich Airport The Circle offers 255 well-appointed and spacious guestrooms, including 16 Regency Suites, 1 Ambassador Suite and 1 Presidential Suite with a terrace overlooking The Park
- Guestroom sizes range from 27 sq m to 130 sq m
- Regency Club guests will have access to the Regency Club Lounge, situated on the 9th floor, offering its own private terrace with park views
- Two unique and locally sourced food & beverage offerings: Babel, a restaurant to enjoy unexpected Middle Eastern flavors in a lively atmosphere; and Iris, a bar with a modern and bold Swiss-design vibe, serving cocktails and Swiss-inspired shareable plates with views over the Circle's main square

Hyatt Place Zurich Airport The Circle

- Hyatt Place Zurich Airport The Circle offers 300 comfortable guestrooms with thoughtful and intuitive design
- Conveniently located opposite to Zurich Airport, at the Nordplatz, the hotel provides a stylish and seamless experience to their guests
- Guests will be able to enjoy the Glocal Dining Concept, in the Zoom Restaurant & Bar open throughout the day.
- 24/7 Fitness Center

The Circle

Convention Center
Zurich Airport

CAPACITY CHART



Room Name	Room Dimensions L x W x H	Room Size Sq. M.	Reception	Banquet Round Tables	Banquet Rectangular Tables	Theater	Classroom	Boardroom	U-Shape	Hollow Square	Cabaret
Level 1											
ENTRY FOYER	—	350	120	—	—	—	—	—	—	—	—
Level 2											
FOYER (Section A - C)	—	360	200	—	—	—	—	—	—	—	—
FOYER (Section A)	—	1,060	525	—	—	—	—	—	—	—	—
CONVENTION HALL	23.5m x 51.5m x 13.1m	1,292	1500*	850*	1,242*	1'500*	870*	—	—	—	576*
Section A	23.5m x 16.5m x 13.1m	435	500*	280*	360*	493*	312*	66*	66*	84*	144*
Section B	23.5m x 18.5m x 13.1m	435	500*	280*	360*	493*	312*	66*	66*	84*	144*
Section C	23.5m x 18.5m x 13.1m	388	450*	250*	348*	442*	273*	66*	66*	84*	120*
Section A + B	23.5m x 35m x 13.1m	870	1000	570*	810*	975	606	—	—	—	288
Section B + C	23.5m x 35m x 13.1m	823	950	540*	780*	936	576	—	—	—	264
FOYER (Venue 1 - 4)	—	—	—	—	—	—	—	—	—	—	—
MEETING ROOM 1 Rotbuche	13.0m x 9.0m x 3.1m	117	160	80	120	120	90	36	36	42	48
MEETING ROOM 2 Waldkiefer	13.0m x 8.5m x 3.1m	111	180	100	120	130	90	36	39	42	56
MEETING ROOM 1 + 2	13.0m x 17.5m x 3.1m	228	220	210	240	250	187	60	63	72	104
MEETING ROOM 3 Feldahorn	12.5m x 9.0m x 3.1m	113	150	80	96	108	62	30	30	36	48
MEETING ROOM 4 Bergahorn	11.5m x 6.5m x 3.1m	75	90	50	48	70	38	24	21	24	24
MEETING ROOM 3 + 4	11.5m x 15.5m x 3.1m	178	240	140	146	178	108	48	47	44	80
Level 3											
FOYER (Venue 5 - 8)	—	—	—	—	—	—	—	—	—	—	—
MEETING ROOM 5 Vogelbeere	14.5m x 9.0m x 2.8m	131	185	80	—	137	96	42	45	48	40
MEETING ROOM 6 Vogelkirsche	14.5m x 10.0m x 2.8m	145	190	80	—	148	96	42	39	42	48
MEETING ROOM 7 Grauerle	11.0m x 14.0m x 2.8m	154	195	70	—	144	96	36	36	42	48
MEETING ROOM 8 Schwarzerle	8.5m x 9.0m x 2.8m	77	90	30	—	69	42	18	21	24	24
FOYER (Venue 9 + 10)	—	—	—	—	—	—	—	—	—	—	—
MEETING ROOM 9 Traubeneiche	10.0m x 4.8m x 2.7m	48	50	20	—	39	30	24	21	24	—
MEETING ROOM 10 Stieleiche	10.0m x 5.2m x 2.7m	52	50	20	—	42	24	24	21	24	—
MEETING ROOM 9 + 10	10.0m x 10m x 2.7m	100	120	40	—	84	54	24	27	30	32
MEETING ROOM 11 Hainbuche	12.0m x 7.0m x 2.7m	118 84**	150	60	—	73	45	30	27	30	32
MEETING ROOM 12 Sanddorn	8.0m x 7.0m x 2.7m	56	40	20	—	36	33	18	15	18	—
MEETING ROOM 13 Schlehdorn	5.5m x 6.0m x 2.4m	33	25	10	—	24	18	12	9	12	—
Level 4											
FOYER (Venue 14 + 15)	—	—	—	—	—	—	—	—	—	—	—
MEETING ROOM 14 Waldmeister	11.5m x 5.0m x 2.5m	58	40	—	—	42	36	24	27	24	—
MEETING ROOM 15 Eichenfarn	11.0m x 5.0m x 2.5m	55	40	—	—	42	36	24	27	24	—
MEETING ROOM 16 Schlüsselblume	9.0m x 4.5m x 2.5m	41	30	—	—	28	20	16	15	18	—
MEETING ROOM 17 Bärlauch	7.5m x 8.0m x 2.5m	60	40	—	—	40	32	18	15	18	—

* Capacities excluding stage ** reduced capacity depending on room set up

All above mentioned capacities are subject to change based on local laws, regulations and guidance, and the hotel's and Hyatt's policies

The Circle

Convention Center
Zurich Airport

FLOORPLANS

1. Etage



2. Etage

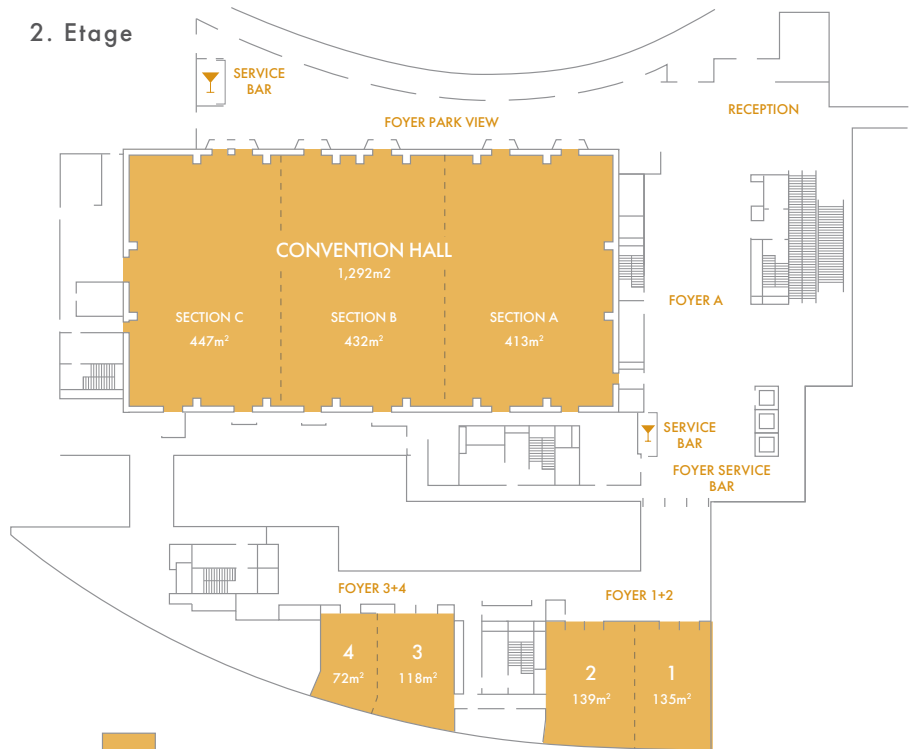

3. Etage

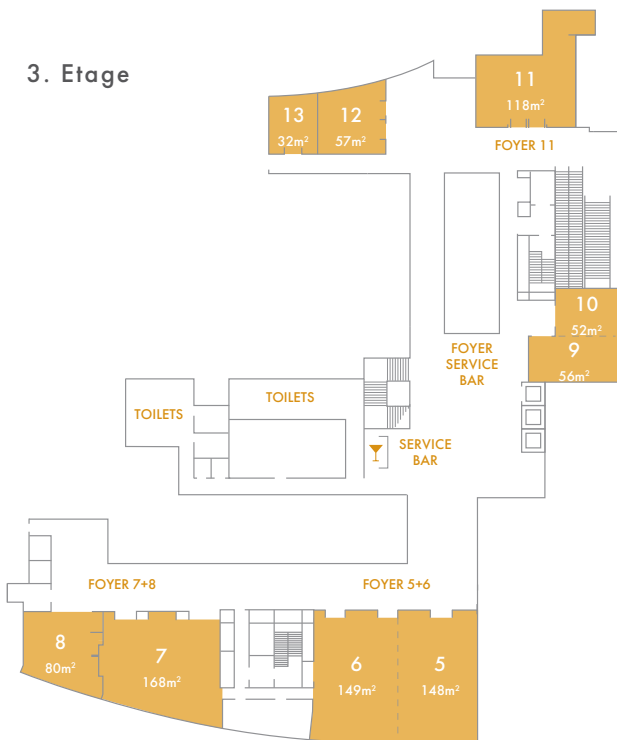

Level 4

