

# The Circle

Convention Center  
Zurich Airport



## LOCATION

- Located in the heart of the Circle, the new destination in Zurich, where business meets lifestyle and nature
- Within walking distance from Zurich Airport
- The Circle combines seven modules with Brands & Dialogue, Headquarters & Offices, Hotels & Convention, Dining & Events, Health & Beauty, Art & Culture and Education & Knowledge
- Situated at the most accessible and most well-connected location in Switzerland, directly connected with the city center of Zurich by all means of transportation

## THE CIRCLE CONVENTION CENTER

- Over 2,800 sq m of flexible event space
- All event rooms offer an abundance of natural daylight with floor-to-ceiling windows
- The main Convention Hall is the largest space at The Circle Convention Center with 1,292 sq m
- 17 additional meeting rooms ranging from 30 to 290 sq m spread over 3 levels
- Managed and catered by Hyatt Regency Zurich Airport The Circle
- All event rooms are equipped with the latest technologies
- Dedicated in-house audiovisual services
- Complimentary high-speed Wi-Fi connection in all event rooms and public areas
- Virtual studio for digital events

## ACCOMMODATION

- The Circle Convention Center is directly connected to Hyatt Regency Zurich Airport The Circle and within walking distance from Hyatt Place Zurich Airport The Circle, both hotels offering a combined capacity of 555 guestrooms

### Hyatt Regency Zurich Airport The Circle

- Hyatt Regency Zurich Airport The Circle offers 255 well-appointed and spacious guestrooms, including 16 Regency Suites, 1 Ambassador Suite and 1 Presidential Suite with a terrace overlooking The Park
- Guestroom sizes range from 27 sq m to 130 sq m
- Regency Club guests will have access to the Regency Club Lounge, situated on the 9th floor, offering its own private terrace with park views
- Two unique and locally sourced food & beverage offerings: Babel, a restaurant to enjoy unexpected Middle Eastern flavors in a lively atmosphere; and Iris, a bar with a modern and bold Swiss-design vibe, serving cocktails and Swiss-inspired shareable plates with views over the Circle's main square

### Hyatt Place Zurich Airport The Circle

- Hyatt Place Zurich Airport The Circle offers 300 comfortable guestrooms with thoughtful and intuitive design
- Conveniently located opposite to Zurich Airport, at the Nordplatz, the hotel provides a stylish and seamless experience to their guests
- Guests will be able to enjoy the Global Dining Concept, in the Zoom Restaurant & Bar open throughout the day.
- 24/7 Fitness Center

# The Circle

Convention Center  
Zurich Airport

## CAPACITY CHART



Room Name	Room Dimensions L x W x H	Room Size Sq. M.	Reception	Banquet Round Tables	Banquet Rectangular Tables	Theater	Classroom	Boardroom	U-Shape	Hollow Square	Cabaret
<b>Level 1</b>											
ENTRY FOYER	—	350	120	—	—	—	—	—	—	—	—
<b>Level 2</b>											
FOYER (Section A – C)	—	360	200	—	—	—	—	—	—	—	—
FOYER (Section A)	—	1,060	525	—	—	—	—	—	—	—	—
CONVENTION HALL	23.5m x 51.5m x 13.1m	1,292	1500*	850*	1,242*	1'500*	870*	—	—	—	576*
Section A	23.5m x 16.5m x 13.1m	435	500*	280*	360*	493*	312*	66*	66*	84*	144*
Section B	23.5m x 18.5m x 13.1m	435	500*	280*	360*	493*	312*	66*	66*	84*	144*
Section C	23.5m x 18.5m x 13.1m	388	450*	250*	348*	442*	273*	66*	66*	84*	120*
Section A + B	23.5m x 35m x 13.1m	870	1000	570*	810*	975	606	—	—	—	288
Section B + C	23.5m x 35m x 13.1m	823	950	540*	780*	936	576	—	—	—	264
FOYER (Venue 1 - 4)	—	—	—	—	—	—	—	—	—	—	—
MEETING ROOM 1 Rotbuche	13.0m x 9.0m x 3.1m	117	160	80	120	120	90	36	36	42	48
MEETING ROOM 2 Waldkiefer	13.0m x 8.5m x 3.1m	111	180	100	120	130	90	36	39	42	56
MEETING ROOM 1 + 2	13.0m x 17.5m x 3.1m	228	220	210	240	250	187	60	63	72	104
MEETING ROOM 3 Feldahorn	12.5m x 9.0m x 3.1m	113	150	80	96	108	62	30	30	36	48
MEETING ROOM 4 Bergahorn	11.5m x 6.5m x 3.1m	75	90	50	48	70	38	24	21	24	24
MEETING ROOM 3 + 4	11.5m x 15.5m x 3.1m	178	240	140	146	178	108	48	47	44	80
<b>Level 3</b>											
FOYER (Venue 5 - 8)	—	—	—	—	—	—	—	—	—	—	—
MEETING ROOM 5 Vogelbeere	14.5m x 9.0m x 2.8m	131	185	80	—	137	96	42	45	48	40
MEETING ROOM 6 Vogelkirsche	14.5m x 10.0m x 2.8m	145	190	80	—	148	96	42	39	42	48
MEETING ROOM 7 Grauerle	11.0m x 14.0m x 2.8m	154	195	140	—	144	96	36	36	42	48
MEETING ROOM 8 Schwarzerle	8.5m x 9.0m x 2.8m	77	90	30	—	69	42	18	21	24	24
FOYER (Venue 9 + 10)	—	—	—	—	—	—	—	—	—	—	—
MEETING ROOM 9 Traubeneiche	10.0m x 4.8m x 2.7m	48	50	20	—	39	30	24	21	24	—
MEETING ROOM 10 Stieleiche	10.0m x 5.2m x 2.7m	52	50	20	—	42	24	24	21	24	—
MEETING ROOM 9 + 10	10.0m x 10m x 2.7m	100	120	40	—	84	54	24	27	30	32
MEETING ROOM 11 Hainbuche	12.0m x 7.0m x 2.7m	118   84**	150	60	—	73	45	30	27	30	32
MEETING ROOM 12 Sanddorn	8.0m x 7.0m x 2.7m	56	40	20	—	36	33	18	15	18	—
MEETING ROOM 13 Schlehdorn	5.5m x 6.0m x 2.4m	33	25	10	—	24	18	12	9	12	—
<b>Level 4</b>											
FOYER (Venue 14 + 15)	—	—	—	—	—	—	—	—	—	—	—
MEETING ROOM 14 Waldmeister	11.5m x 5.0m x 2.5m	58	40	—	—	42	36	24	27	24	—
MEETING ROOM 15 Eichenfarn	11.0m x 5.0m x 2.5m	55	40	—	—	42	36	24	27	24	—
MEETING ROOM 16 Schlüsselblume	9.0m x 4.5m x 2.5m	41	30	—	—	28	20	16	15	18	—
MEETING ROOM 17 Bärlauch	7.5m x 8.0m x 2.5m	60	40	—	—	40	32	18	15	18	—

\* Capacities excluding stage \*\* reduced capacity depending on room set up

All above mentioned capacities are subject to change based on local laws, regulations and guidance, and the hotel's and Hyatt's policies

# The Circle

Convention Center  
Zurich Airport

## FLOORPLANS

### 1. Etage



### 2. Etage

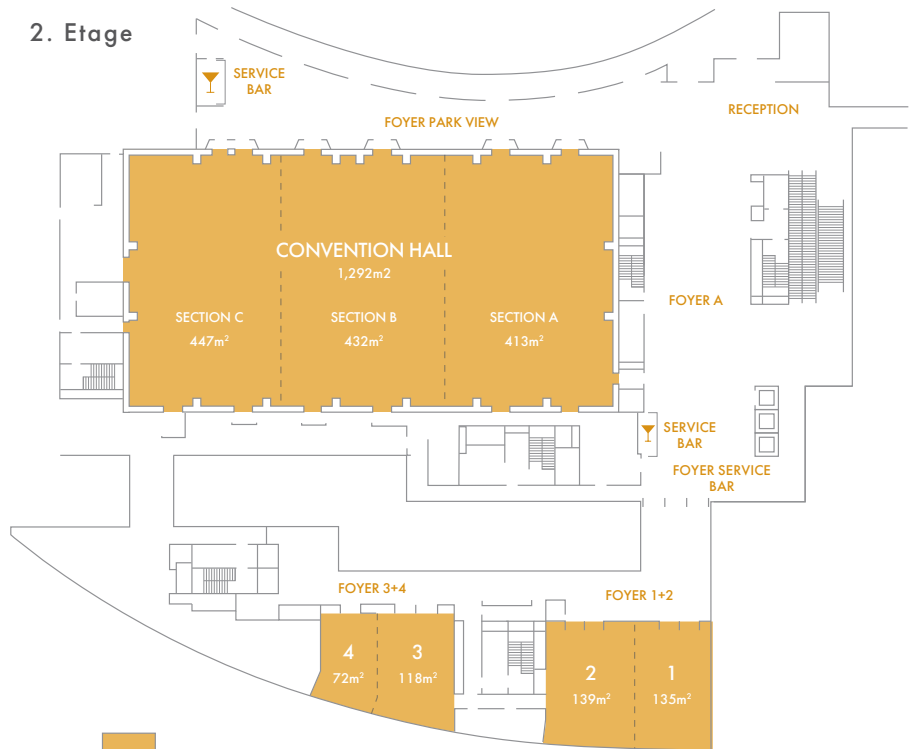

### 3. Etage

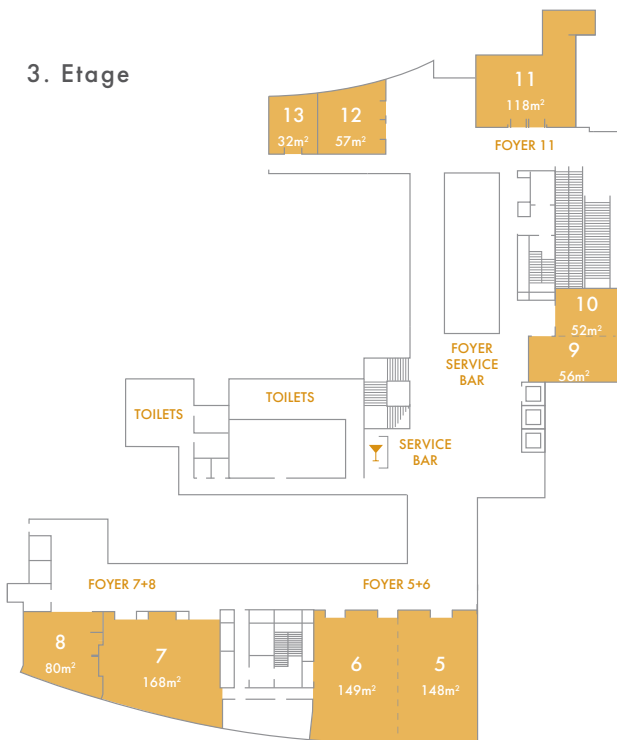

### Level 4

